

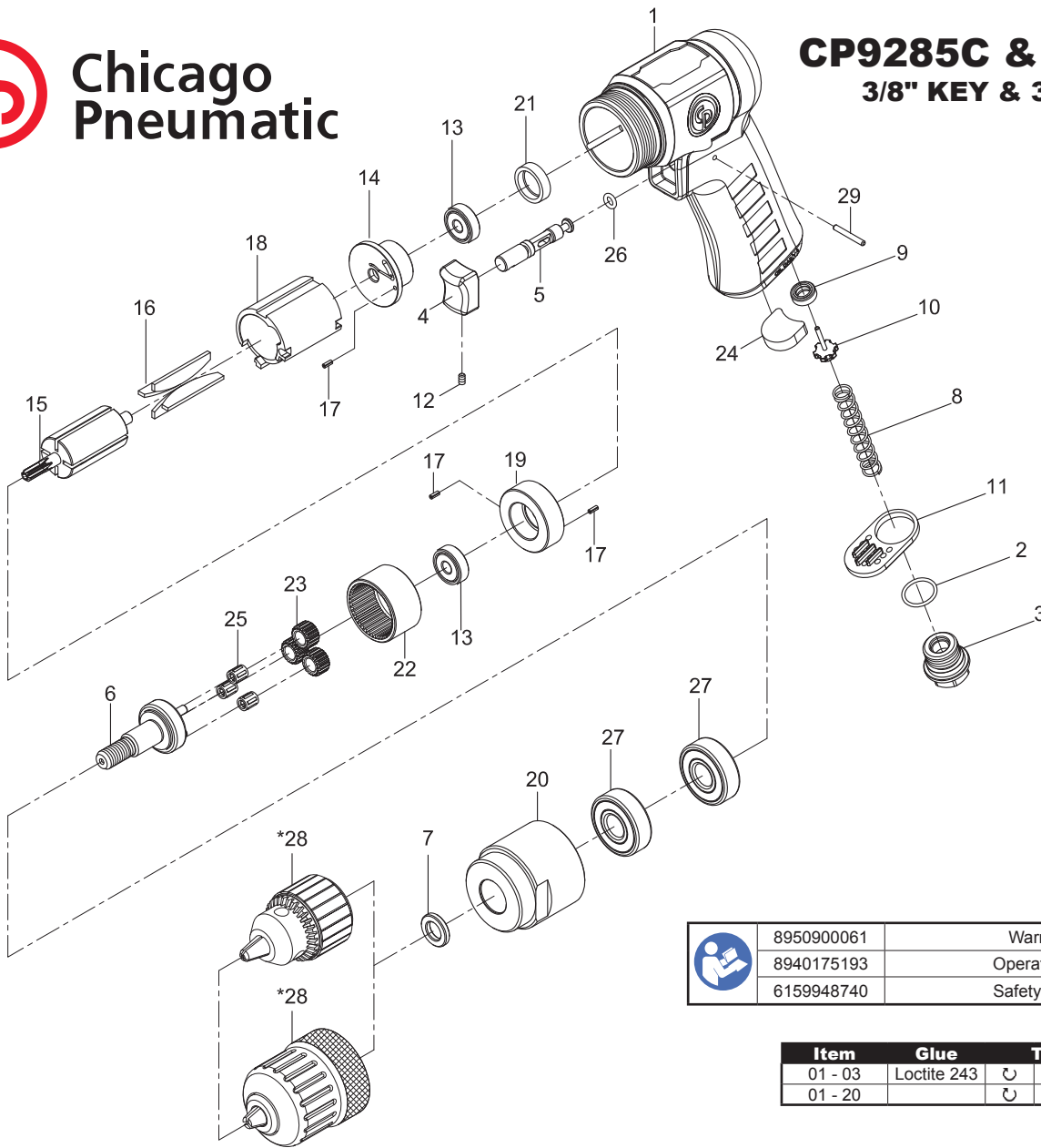

**Chicago
Pneumatic**

CP9285C & CP9287C
3/8" KEY & 3/8" KEY LESS
DRILL
Serie D



	8950900061	Warning Label
	8940175193	Operator's Manual
	6159948740	Safety Instructions

Item	Glue	Tightening torque
01 - 03	Loctite 243	7.3 ft.lb - 10 Nm
01 - 20		36.9 ft.lb - 50Nm

Ref	CP Part No.	Description	Q'ty
A	8940175265	Throttle Kit	
8		Spring	1
9		Valve Seal	1
10		Valve	1
B	8940175266	Inlet Kit	
2		O-Ring	1
3		Air Inlet	1
11		Silencer	1
C	8940175293	Motor Housing Kit	
1	8940175262	Motor Housing with grip	1
4		Trigger	1
5		Valve Stem	1
12		Stem Screw	1
26		O-Ring	1
29		Pin	1
D	8940175267	Trigger Kit	1
		Include 4, 5, 12, 26, 29	
E	8940175282	Rear End Plate	
13		Ball Bearing (626zz)	1
14		Rear End Plate	1
17		Spring Pin	1
21		Cap	1
F	8940175283	Front Plate Kit	
13		Ball Bearing (626zz)	1
17		Spring Pin	2
19		Front End Plate	1

Ref	CP Part No.	Description	Q'ty
G	8940175284	Gearbox Kit	
6		Work Spindle	1
22		Internal Gear	1
23		Planet Gear	3
25		Needle Bearing	3
H	8940175287	Service Gear Set	
		Include 23(x3) & 25 (x3)	
SP	8940175285	Small Parts Kit	
		Include 3, 7, 11, 12, 17, 21, 24 & 29	
TK	8940175286	Tune-Up Kit	
		Include 9, 16 & 26	

15	2050485473	Rotor	1
16	2050485483	Rotor Blades (Set of 4)	1
18	8940175264	Cylinder	1
20	2050485513	Clamp Nut	1
27	2050486953	Ball Bearing (6201Z)	2
*28	2050486973	Industrial Key Chuck (3/8") & Key (Not Shown) For CP9285C	1
	2050502063	Industrial Keyless Chuck (3/8") For CP9287C	1

*Optional parts

Recommended Accessories



Protecto-lube Oil (for air lubrication)
CA149661 (4 oz - 0.12 l)
CA000046 (20 oz - 0.59 l)



Airoilene Oil (to clean motor parts)
P089507 (1 gal - 3.8 l)